

PLT1



Caratteristiche tecniche

- Norma: ISO 16028 – HTMA (DN13)
- Occlusione: faccia piana
- Aggancio: sfere radiali
- Materiale: acciaio
- Finitura: Zn-Fe (Cr III)
- Filettature: BSP - NPT
- Guarnizioni standard: NBR
- Temperatura d'esercizio: -25 °C +100 °C
- Guarnizioni opzionali: FKM, EPDM o altro
- Pressioni di esercizio: 250-300 bar
- Connessione in pressione: non consentita

Nominal size				Max working pressure	Rated flow	Max flow rate	Min burst pressure			Fluid spillage
DNP	BG	ISO	mm				Male	Female	Coupled	
06	1	6.3	6	30	12	24	180	120	140	0,008
13	2	10	8,6	25	23	46	160	100	160	0,010
20	3	12.5	10,7	25	45	90	150	110	190	0,012
25	4	19	14,8	25	100	200	140	110	140	0,020
30	5	25	17,6	25	189	280	130	100	140	0,030
39	7	40	30	25	379	700	120	120	110	0,050
50	8	50	40,6	25	757	1000	100	100	100	0,100

Technical data

- Standard: ISO 16028 – HTMA (DN13)
- Occlusion: flat face
- Locking: radial balls
- Material: steel
- Finishing: Zn-Fe (Cr III)
- Threads: BSP – NPT
- Standard seals: NBR
- Working temperature: -25 °C +100 °C
- Optional seals: FKM, EPDM or more
- Working pressure: 250-300 bar
- Connection under pressure: not allowed

Technische Merkmale

- Norm: ISO 16028 – HTMA (DN13)
- Verschluss: flachdichtend
- Kupplung: Radialkugeln
- Werkstoff: Stahl
- Ausführung: Zn-Fe (Cr III)
- Gewinde: BSP – NPT
- Standard-Dichtungen: NBR
- Betriebstemperatur: -25 °C +100 °C
- Dichtungen nach Wahl: FKM, EPDM, usw.
- Betriebsdruck: 250-300 bar
- Kuppeln unter Druck: nicht möglich

Caracteristiques techniques

- Norme: ISO 16028 – HTMA (DN13)
- Obturation: clapet plat
- Accrochage: billes radiales
- Matériel: acier
- Traitement: Zn-Fe (Cr III)
- Taraudage: BSP – NPT
- Joints standard: NBR
- Température de service: -25 °C +100 °C
- Joints facultatifs: FKM, EPDM, ect.
- Pression de service: 250-300 bar
- Connexion sous pression: pas possible

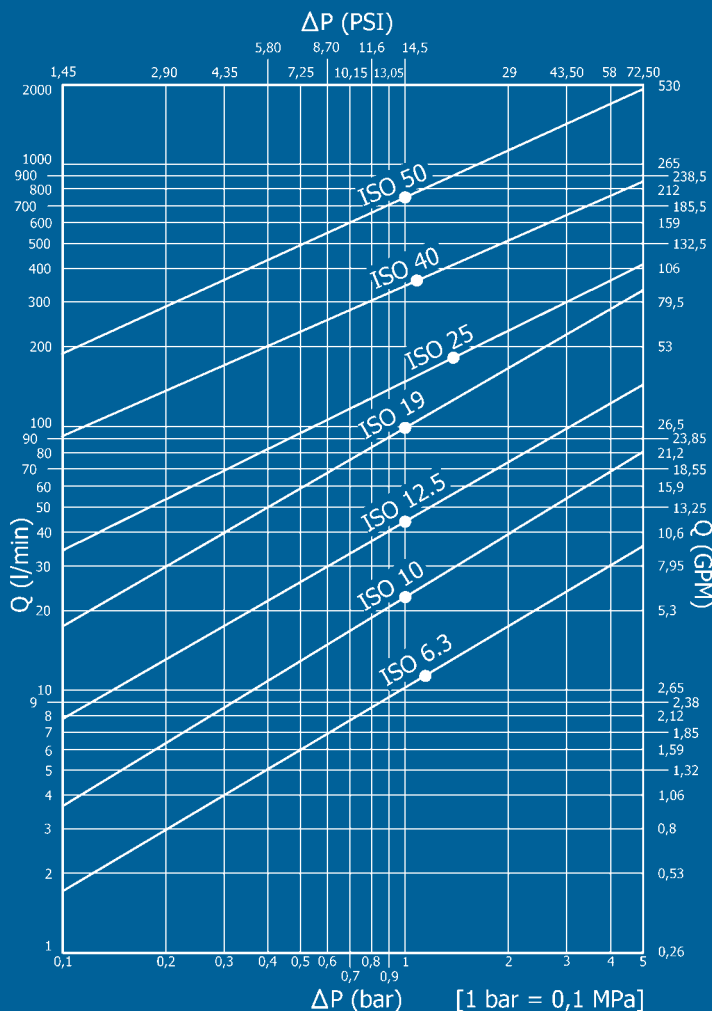

PLT1 DN06 - BG 1 - ISO 6.3

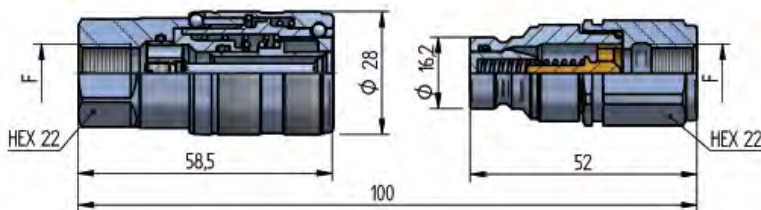

F	STANDARD	FEMMINA - FEMALE - MUFFE - FEMELLE			MASCHIO - MALE - STECKER - MALE		
		COD. F	Weight (g)	Packaging (pcs.)	COD. M	Weight (g)	Packaging (pcs.)
BSP 1/4"	DIN 3852-2-X	PLT1.0606.002	181	100	PLT1.0606.003	99	200
NPT 1/4"	ANSI B1.20.3	PLT1.0606.012	181	100	PLT1.0606.013	99	200

PLT1 DN13 - BG 2 - ISO 10

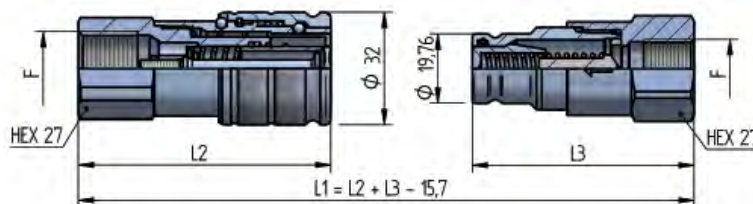

L2	L3	F	STANDARD	FEMMINA - FEMALE - MUFFE - FEMELLE			MASCHIO - MALE - STECKER - MALE		
				COD. F	Weight (g)	Packaging (pcs.)	COD. M	Weight (g)	Packaging (pcs.)
67,3	63,5	BSP 3/8"	DIN 3852-2-X	PLT1.1310.002	256	60	PLT1.1310.003	156	76
67,3	63,5	NPT 3/8"	ANSI B1.20.3	PLT1.1310.012	259	60	PLT1.1310.013	159	76
72,3	67,5	BSP 1/2"	DIN 3852-2-X	PLT1.1313.002	253	60	PLT1.1313.003	151	76
72,3	67,5	NPT 1/2"	ANSI B1.20.3	PLT1.1313.012	256	60	PLT1.1313.013	154	76

PLT1 DN20 - BG 3 - ISO 12.5

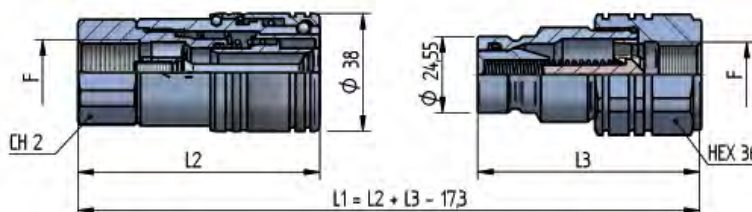

CH2	L2	L3	F	STANDARD	FEMMINA - FEMALE - MUFFE - FEMELLE			MASCHIO - MALE - STECKER - MALE		
					COD. F	Weight (g)	Packaging (pcs.)	COD. M	Weight (g)	Packaging (pcs.)
32	78,5	72,5	BSP 1/2"	DIN 3852-2-X	PLT1.2013.002	413	35	PLT1.2013.003	305	42
32	84	74	NPT 1/2"	ANSI B1.20.3	PLT1.2013.012	408	35	PLT1.2013.013	314	42
36	84	74,5	BSP 3/4"	DIN 3852-2-X	PLT1.2019.002	445	35	PLT1.2019.003	282	42
36	84	74	NPT 3/4"	ANSI B1.20.3	PLT1.2019.012	451	35	PLT1.2019.013	290	42

PLT1 DN25 - BG 4 - ISO 19

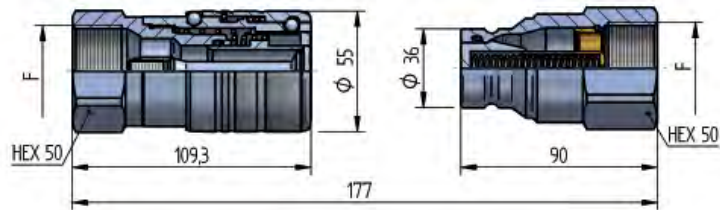

F	STANDARD	FEMMINA - FEMALE - MUFFE - FEMELLE			MASCHIO - MALE - STECKER - MALE		
		COD. F	Weight (g)	Packaging (pcs.)	COD. M	Weight (g)	Packaging (pcs.)
BSP 3/4"	DIN 3852-2-X	PLT1.2519.002	850	23	PLT1.2519.003	492	30
NPT 3/4"	ANSI B1.20.3	PLT1.2519.012	857	23	PLT1.2519.013	500	30
BSP 1"	DIN 3852-2-X	PLT1.2525.002	789	23	PLT1.2525.003	439	30
NPT 1"	ANSI B1.20.3	PLT1.2525.012	801	23	PLT1.2525.013	440	30

PLT1 DN30 - BG 5 - ISO 25

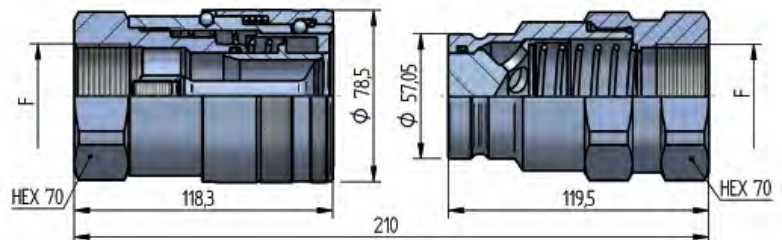
F	STANDARD	FEMMINA - FEMALE - MUFFE - FEMELLE			MASCHIO - MALE - STECKER - MALE		
		COD. F	Weight (g)	Packaging (pcs.)	COD. M	Weight (g)	Packaging (pcs.)
BSP 1 1/4"	DIN 3852-2-X	PLT1.3031.002	1139	7	PLT1.3031.003	648	20
NPT 1 1/4"	ANSI B1.20.3	PLT1.3031.012	1162	7	PLT1.3031.013	661	20

PLT1 DN39 - BG 7 - ISO 40

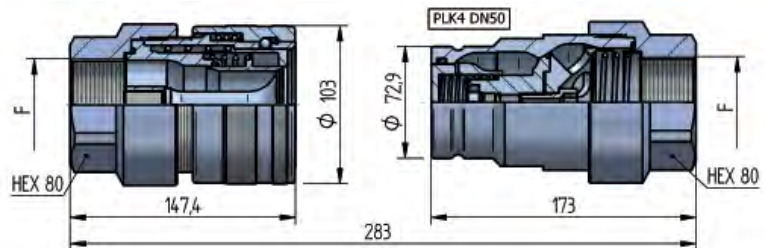
F	STANDARD	FEMMINA - FEMALE - MUFFE - FEMELLE			MASCHIO - MALE - STECKER - MALE		
		COD. F	Weight (g)	Packaging (pcs.)	COD. M	Weight (g)	Packaging (pcs.)
BSP 1 1/2"	DIN 3852-2-X	PLT1.3939.002	2703	5	PLT1.3939.003	1879	9
NPT 1 1/2"	ANSI B1.20.3	PLT1.3939.012	2718	5	PLT1.3939.013	1893	9

PLT1 DN50 - BG 8 - ISO 50

F	STANDARD	FEMMINA - FEMALE - MUFFE - FEMELLE			MASCHIO - MALE - STECKER - MALE		
		COD. F	Weight (g)	Packaging (pcs.)	COD. M	Weight (g)	Packaging (pcs.)
BSP 2"	DIN 3852-2-X	PLT1.5051.112	5500	3	PLK4.5051.113	4890	3
NPT 2"	ANSI B1.20.3	PLT1.5051.012	5400	3	PLK4.5051.013	4790	3
1 1/2"	SAE 3000	PLT1.5051.002	6440	3	PLK4.5051.003	5830	3

PLASTIC



NOMINAL SIZE			FEMALE DUST PLUG			MALE DUST CAP			COLOUR	MATERIAL
DNP	BG	ISO	COD. F	Weight (g)	Packaging (pcs.)	COD. M	Weight (g)	Packaging (pcs.)		
06	1	6.3	SPLT.06002	16	50	SPLT.06003	13	100	RED	PVC
13	2	10	SPLT.13002	21	50	SPLT.13003	15	100	RED	PVC
20	3	12.5	SPLT.20002	29	25	SPLT.20003	26	50	RED	PVC
25	4	19	SPLT.25002	51	20	SPLT.25003	41	40	RED	PVC
30	5	25	SPLT.30002	87	12	SPLT.30003	64	30	RED	PVC

METAL



NOMINAL SIZE			FEMALE DUST PLUG			MALE DUST CAP			COLOUR	MATERIAL
DNP	BG	ISO	COD. F	Weight (g)	Packaging (pcs.)	COD. M	Weight (g)	Packaging (pcs.)		
06	1	6.3	SPLT.06202*	40	100	SPLT.06203*	35	150	-	Aluminium
13	2	10	SPLT.13202*	51	50	SPLT.13203*	40	100	-	Aluminium
20	3	12.5	SPLT.20202*	100	30	SPLT.20203*	65	50	-	Aluminium
25	4	19	SPLT.25202*	120	20	SPLT.25203*	80	30	-	Aluminium
30	5	25	SPLT.30202*	155	10	SPLT.30203*	100	20	-	Aluminium
39	7	40	SPLT.39202*	199	5	SPLT.39203*	136	10	-	Aluminium
50	8	50	SPLT.50202*	352	3	SPLK.50203*	199	5	-	Aluminium

* REALIZZATI SU RICHIESTA DEL CLIENTE - AVAILABLE ON REQUEST - AUF ANFRAGE LIEFERBAR - DISPONIBLES SUR DEMANDE

AUTOMATIC

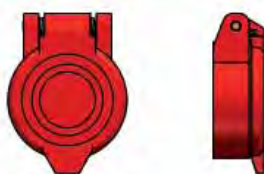

NOMINAL SIZE			AUTOMATIC FEMALE CAP			COLOUR	MATERIAL
DNP	BG	ISO	COD. F	Weight (g)	Packaging (pcs.)		
13	2	10	SPLT.13302	17	100	RED	Nylon
13	2	10	SPLT.13342	17	100	BLACK	Nylon
20	3	12.5	SPPV.13302	22	100	BLACK	Nylon
20	3	12.5	SPPV.13312	22	100	YELLOW	Nylon
20	3	12.5	SPPV.13322	22	100	GREEN	Nylon
20	3	12.5	SPPV.13332	22	100	BLUE	Nylon
20	3	12.5	SPPV.13342	22	100	RED	Nylon

GUARNIZIONI DI RICAMBIO / SPARE PARTS / ERSATZDICHTUNGEN / JOINTS

AL CODICE DELLA GUARNIZIONE IN NBR AGGIUNGERE 'E' PER EPDM o 'V' PER VITON

TO THE NBR GASKET CODE ADD 'E' FOR EPDM OR 'V' FOR VITON

ZU DER ARTIKELNR. DER NBR DICHTUNG GEBEN SIE 'E' FUER EPDM ODER 'V' FUER VITON AN

AU CODE DU JOINT EN NBR JOINDRE 'E' POUR EPDM OU 'V' POUR VITON

NOMINAL SIZE			FEMALE GASKET		MALE GASKET	
DNP	BG	ISO	NBR	PTFE	NBR	PTFE
06	1	6.3	PLT.006.121	PLT.006.131 N	PLT.006.120	PLT.006.130
13	2	10	PLT.013.121	PLT.013.131	PLT.013.120	PLT.013.130
20	3	12.5	PLT.019.121	PLT.019.131 N	PLT.019.120	PLT.019.130
25	4	19	PLT.025.121	PLT.025.131 N	PLT.025.120	PLT.025.130
30	5	25	PLT.031.121	PLT.031.131 N	PLT.031.120	PLT.031.130
39	7	40	PLT.039.121	PLT.039.131	PLT.039.120	PLT.039.130
50	8	50	PLT.050.121	PLT.050.131	PLK.050.120	PLK.050.130