

DRAWING No. 016328

| ISSUE | CHANGE | DATE | CHK. |
|-------|--------|-------|------|
| A | | 07.07 | F.S |
| B | | 01.12 | FS |

DO NOT SCALE

IF IN DOUBT - MKC

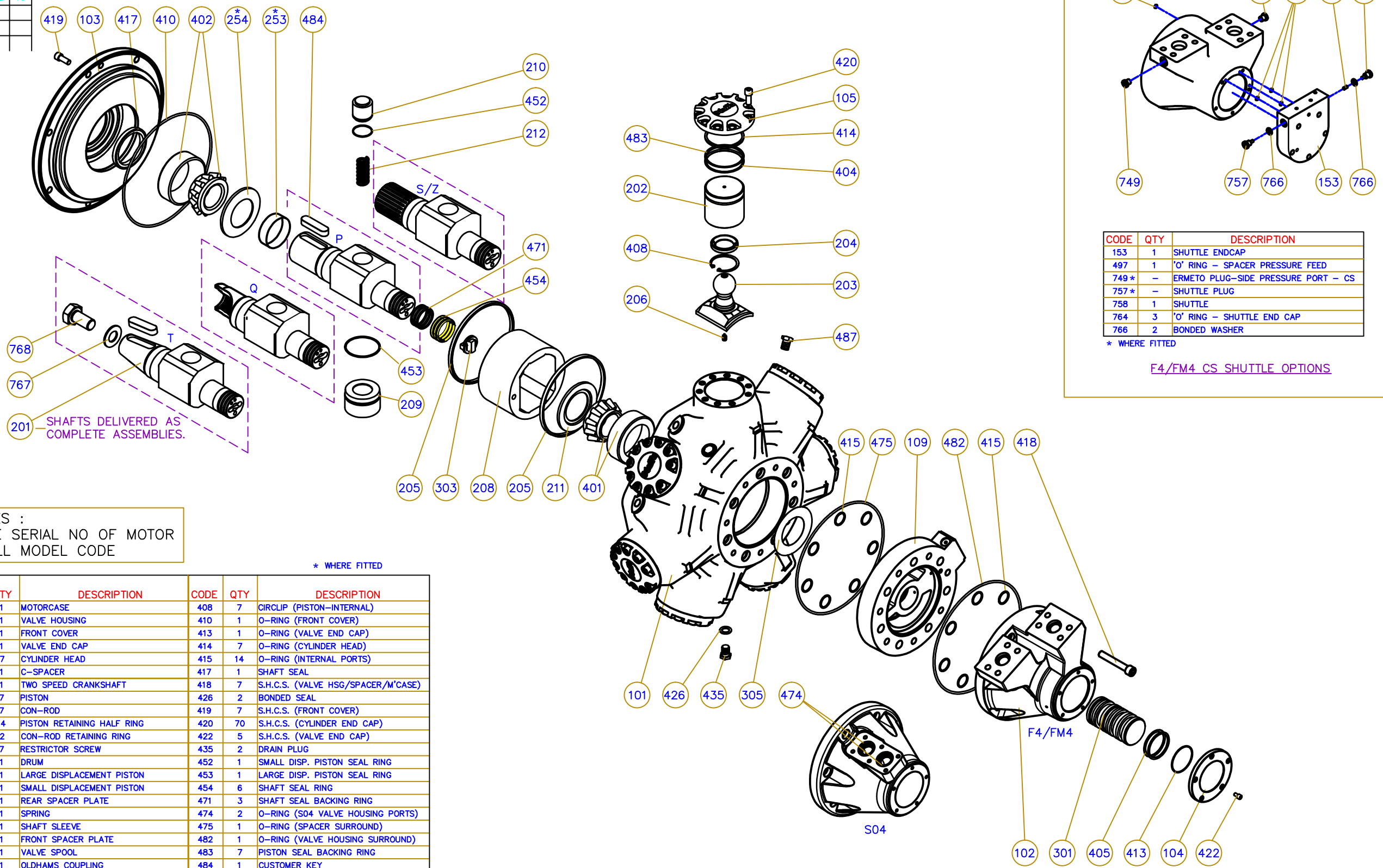

201 - SHAFTS DELIVERED AS COMPLETE ASSEMBLIES.

| CODE | QTY | DESCRIPTION |
|------|-----|-------------------------------------|
| 153 | 1 | SHUTTLE ENDCAP |
| 497 | 1 | 'O' RING - SPACER PRESSURE FEED |
| 749* | - | ERMETO PLUG-SIDE PRESSURE PORT - CS |
| 757* | - | SHUTTLE PLUG |
| 758 | 1 | SHUTTLE |
| 764 | 3 | 'O' RING - SHUTTLE END CAP |
| 766 | 2 | BONDED WASHER |

* WHERE FITTED

F4/FM4 CS SHUTTLE OPTIONS

SPARES :
QUOTE SERIAL NO OF MOTOR
+ FULL MODEL CODE

* WHERE FITTED

| CODE | QTY | DESCRIPTION | CODE | QTY | DESCRIPTION |
|------|-----|----------------------------|------|-----|------------------------------------|
| 101 | 1 | MOTORCASE | 408 | 7 | CIRCLIP (PISTON-INTERNAL) |
| 102 | 1 | VALVE HOUSING | 410 | 1 | O-RING (FRONT COVER) |
| 103 | 1 | FRONT COVER | 413 | 1 | O-RING (VALVE END CAP) |
| 104 | 1 | VALVE END CAP | 414 | 7 | O-RING (CYLINDER HEAD) |
| 105 | 7 | CYLINDER HEAD | 415 | 14 | O-RING (INTERNAL PORTS) |
| 109 | 1 | C-SPACER | 417 | 1 | SHAFT SEAL |
| 201 | 1 | TWO SPEED CRANKSHAFT | 418 | 7 | S.H.C.S. (VALVE HSG/SPACER/M'CASE) |
| 202 | 7 | PISTON | 426 | 2 | BONDED SEAL |
| 203 | 7 | CON-ROD | 419 | 7 | S.H.C.S. (FRONT COVER) |
| 204 | 14 | PISTON RETAINING HALF RING | 420 | 70 | S.H.C.S. (CYLINDER END CAP) |
| 205 | 2 | CON-ROD RETAINING RING | 422 | 5 | S.H.C.S. (VALVE END CAP) |
| 206 | 7 | RESTRICTOR SCREW | 435 | 2 | DRAIN PLUG |
| 208 | 1 | DRUM | 452 | 1 | SMALL DISP. PISTON SEAL RING |
| 209 | 1 | LARGE DISPLACEMENT PISTON | 453 | 1 | LARGE DISP. PISTON SEAL RING |
| 210 | 1 | SMALL DISPLACEMENT PISTON | 454 | 6 | SHAFT SEAL RING |
| 211 | 1 | REAR SPACER PLATE | 471 | 3 | SHAFT SEAL BACKING RING |
| 212 | 1 | SPRING | 474 | 2 | O-RING (S04 VALVE HOUSING PORTS) |
| 253* | 1 | SHAFT SLEEVE | 475 | 1 | O-RING (SPACER SURROUND) |
| 254* | 1 | FRONT SPACER PLATE | 482 | 1 | O-RING (VALVE HOUSING SURROUND) |
| 301 | 1 | VALVE SPOOL | 483 | 7 | PISTON SEAL BACKING RING |
| 303 | 1 | OLDHAMS COUPLING | 484 | 1 | CUSTOMER KEY |
| 305 | - | SHIM (STEEL) | 487 | 1 | PLASTIC PLUG |
| 401 | 1 | REAR BEARING | 498* | 7 | O-RING RETAINER (LONG) |
| 402 | 1 | FRONT BEARING | 499* | 7 | O-RING RETAINER (SHORT) |
| 404 | 7 | PISTON SEAL RING | 767 | 1 | KEEP PLATE |
| 405 | 12 | VALVE SEAL RING | 768 | 1 | HEX HEAD SCREW |

F4/FM4

S04

| | | | |
|--|-----------------|----------|--|
| THIRD ANGLE PROJECTION | NAME | DATE | |
| | DR. M.NORMAN | 20.08.07 | |
| | CHK. F.STANTON | 28.11.07 | GENERAL ASSEMBLY (FOR SPARES) HMC/HPC MOTOR (270-325) |
| | ENGR. APPL. WT. | | |
| <small>ALL TECHNICAL DATA DISCLOSED HEREIN IS THE PROPERTY OF KPM/STAFFA AND SHALL NOT BE USED BY OTHERS FOR MANUFACTURE, PROCUREMENT OR DISCLOSURE WITHOUT THE WRITTEN PERMISSION OF THE OWNER.</small> | | | SIZE A1 SCALE NTS DRAWING No. 016328 SHEET 1 of 1 |